

Anchor Bolt PERI 14/20 x 130

Item-no.: 124777

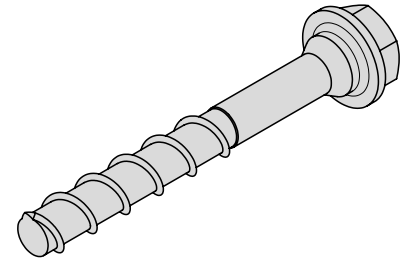

The Anchor Bolt PERI 14/20 x 130 is used for temporary assembly of construction aids on reinforced concrete components.

Further technical information

- For applications requiring approval, please observe the values from approval no. Z-21.8-2115.
- Re-usable (see note)
- Function: form closure

Assembly Instructions

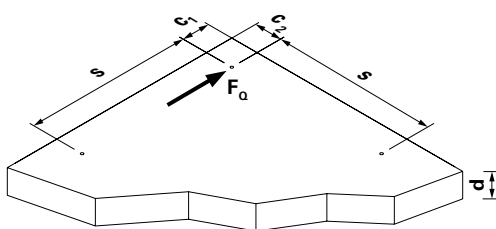
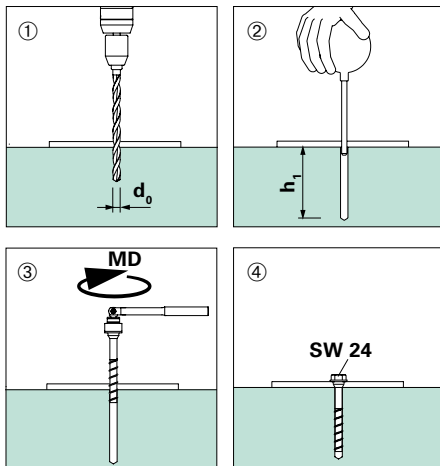

Technical Data

Anchor length	L	130 mm
Fixing thickness	t_{fix}	6 – 12 mm
Anchoring depth	h_{nom}	L – t _{fix}
Depth of drilled hole	h₁	h _{nom} +10 mm
Drill Ø (Hammer Drill DIN 8035)	d_o	14 mm
Tightening torque	MD	50 Nm
Spanner size	SW	24 mm
Minimum axis spacing	s	≥ 500 mm
Minimum distance to edge	c₁, c₂	≥ 500 mm ⁽¹⁾
Minimum thickness of structural member	d	≥ 225 mm
Hole in part to be fixed	d_b	21 – 22 mm
Concrete strength class ≥ C20/25 ≤ C50/60 cracked concrete/non-cracked concrete	perm. F _Z * 11,3 kN 14,0 kN 16,0 kN 18,0 kN	perm. F _Z ⁽²⁾ * 35,0 kN 35,0 kN 35,0 kN 35,0 kN
f _{ck} = 10 N/mm ² , f _{ck,cube} = 12 N/mm ² f _{ck} = 12 N/mm ² , f _{ck,cube} = 15 N/mm ² f _{ck} = 16 N/mm ² , f _{ck,cube} = 20 N/mm ² f _{ck} = 20 N/mm ² , f _{ck,cube} = 25 N/mm ²		

Intermediate values to be interpolated.

For increased requirements on assembly specifications⁽¹⁾, the manufacturer recommends these values⁽²⁾ in transverse loading.

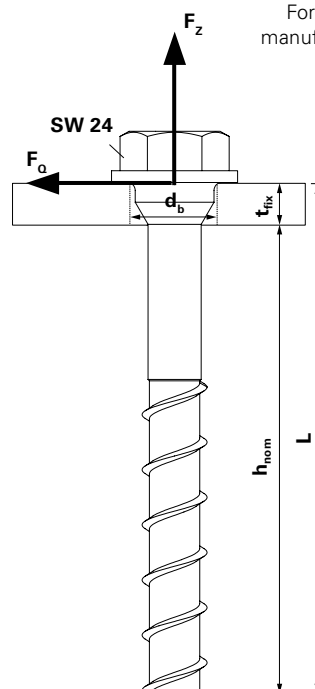

*Interaction Equation

$$\frac{F_z}{\text{perm. } F_z} \leq 1,0 \quad \frac{F_o}{\text{perm. } F_o} \leq 1,0$$

$$\frac{F_z}{\text{perm. } F_z} + \frac{F_o}{\text{perm. } F_o} \leq 1,2$$

Important Note:

Before each re-use, wear effects on the thread together with the associated tube gauge must be checked. The anchor bolt may only be used again if no more than 3 turns of the thread (see illustration) can penetrate the sleeve. Screws with visible damage, e.g. due to corrosion, must not be used.

